

T.41S. R.10 W., W. M.

# MERRILL

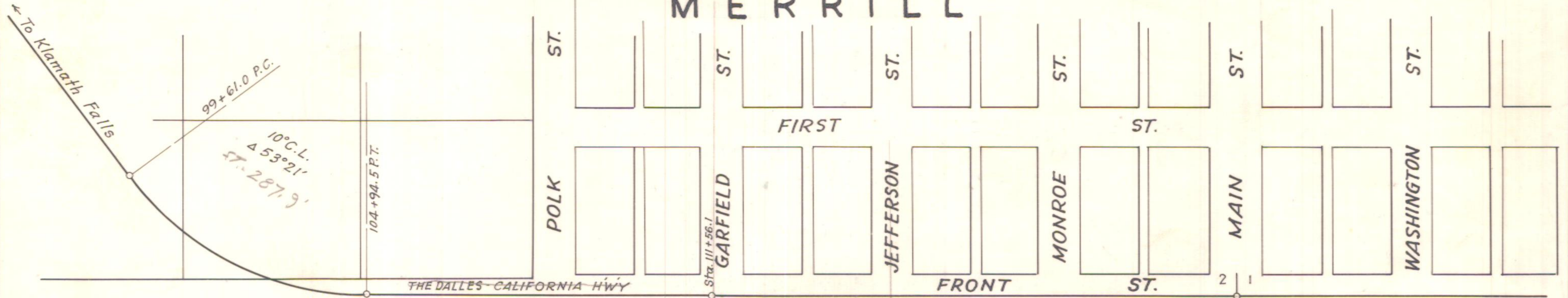

S. 89° 43' E.  
351'

Deed S-131  
Lot 50  
2.65 Ac.  
**Sold**  
351'

330'

330'

Lot 2

49

Lot 3

LOST

RIVER

*Klamath Falls - Malin Hwy.*



OREGON STATE HIGHWAY DEPARTMENT	
Acquired from	<i>Helen Brown &amp; Ethel C. Carey</i>
For	<b>STOCK PILE SITE</b>
Highway	<i>The Dalles-Calif. Hwy.</i>
County	<i>Klamath</i>
Scale	1" = 200'
Date	Dec., 1929

3 B 4-7

4B-6-5

63-223